

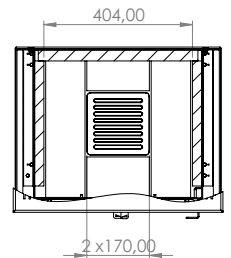

| | |
|-----------------------------|---------------------|
| Output Range | 9-12kw |
| Nominal Efficiency | 75% |
| Fuel Type | Wood |
| Consumption | 2.9kg/hr |
| Flue ø | 150mm |
| Flue exit | Top |
| Measurements (WxDXH) | 570x467x926mm |
| Weight | 87kg |
| Firebox | Steel & vermiculite |
| Finish | Steel |
| Ash tray | Yes |
| Airwash | Yes (adjustable) |
| Warranty | 1 year |

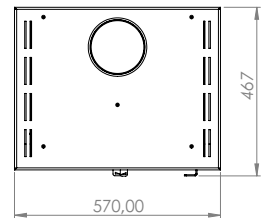
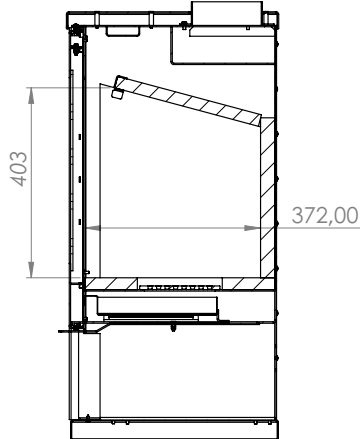
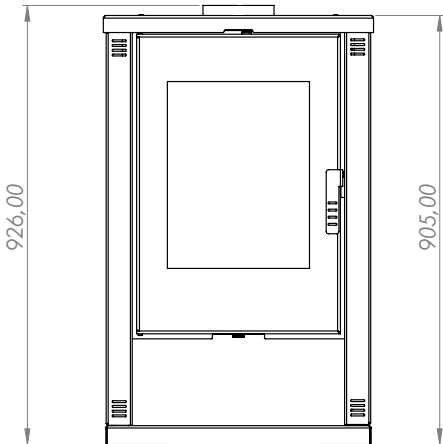

*Unit of measure and model dimensions may vary. E&OE.